

LEGEND

FOUND IRON ROD	FIR
SET IRON ROD	SIR
FOUND IRON PIPE	FIP
FOUND MONUMENT	FM

LEGAL DESCRIPTION:

PART OF SOUTHEAST 1/4 OF SECTION 7 & PART OF THE NORTHEAST 1/4 OF SECTION 18, T5N., R9E., VILLAGE OF ORTONVILLE, OAKLAND COUNTY, MICHIGAN, MORE PARTICULARLY DESCRIBED AS BEGINNING AT A POINT LOCATED DISTANT S 00°15'05" E 1853.85 FEET FROM THE NORTHEAST CORNER OF SAID SECTION 18, THENCE S 00°15'05" E 807.23 FEET TO THE EAST 1/4 CORNER OF SAID SECTION 18, THENCE N 89°43'22" W 8.77 FEET, THENCE N 49°31'58" W 1714.00 FEET, THENCE N 00°25'39" W 219.75 FEET, THENCE N 89°40'56" W 257.64 FEET, THENCE N 49°31'58" W 549.12 FEET TO THE CENTERLINE OF KEARSLEY CREEK, THENCE ALONG THE CENTERLINE OF KEARSLEY CREEK THE FOLLOWING 10 COURSES, N 40°27'40" E 45.00 FEET, THENCE N 05°18'40" W 101.87 FEET, THENCE N 29°41'10" E 90.59 FEET, THENCE N 29°24'10" W 31.95 FEET, THENCE S 74°09'00" W 54.08 FEET, THENCE N 68°49'40" W 42.38 FEET, THENCE N 29°33'10" W 117.05 FEET, THENCE N 03°57'20" W 57.15 FEET, THENCE N 56°30'30" W 90.67 FEET, THENCE N 74°38'20" W 110.50 FEET, THENCE N 15°07'24" E 494.18 FEET, THENCE N 88°47'45" E 909.26 FEET, THENCE N 03°14'13" E 236.20 FEET, THENCE S 78°43'28" E 316.09 FEET, THENCE S 07°32'50" W 213.34 FEET TO NORTH LINE OF SECTION 18, THENCE S 07°32'50" W 448.05 FEET, THENCE S 04°25'40" W 735.00 FEET, THENCE S 24°59'11" E 393.84 FEET, THENCE S 67°56'16" E 770.00 FEET, THENCE N 89°44'55" E 175.00 FEET TO THE POINT OF BEGINNING. SUBJECT TO THE RIGHTS OF THE PUBLIC IN MILL ST & GRANGER ROAD. SUBJECT TO EASEMENTS AND RIGHTS-OF-WAY OF RECORD, IF ANY. PARCEL CONTAINS 47.32 ACRES OF LAND.

SURVEYORS CERTIFICATE:

I HEREBY CERTIFY THAT I HAVE SURVEYED THE PROPERTY DESCRIBED HEREON THAT THE PROPERTY LINES ARE AS SHOWN.

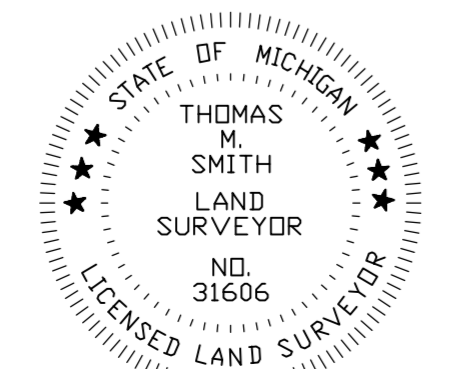

THOMAS M. SMITH
R.L.S. No. 31606

<p>THOMAS M. SMITH P.S. PROFESSIONAL LAND SURVEYOR 7559 OLDE STURBRIDGE TRAIL CLARKSTON, MICHIGAN 48348 tsmith7559@yahoo.com PHONE: (248) 625-3276</p>		PROJECT	MILL ST PROPERTY ORTONVILLE, MI
		TITLE	BOUNDARY SURVEY
ISSUED FOR:	CLIENT	VILLAGE OF ORTONVILLE	
ISSUED FOR:	SCALE HORIZ.	1" = 150'	
ISSUED FOR:	SCALE VERT.	N/A	
ISSUED FOR:	DATE	05-17-18	
ISSUED FOR:	PROJECT No.	18-255	
ISSUED FOR:	SHEET No.	1 of 1	

